

APPENDIX B

Applicant: Mr Anselmo Chiofalo

Location: On the footway outside 80-88 High Street, Croydon, Surrey,
CR0 1NA

Measurements: **Outside no 80** -The measurement from the shop window to the edge of the pavement is 4.85m. The applicant has applied for a display area of 1.9m which leaves a clear pavement width of 2.95m. High Street is maintained by Croydon Council and the required clear pavement width is 2m.

A length of 4.7 m is also applied for

Outside no 82-88- The measurement from the shop window to the edge of the pavement is 5.70m. The applicant has applied for a display area of 2.6 m which leaves a clear pavement width of 3.1m.

A length of 10.4 m is also applied for.

Appendix B1 shows a plan of the site.

Appendices B2 & B3 are photographs of the display at no 80.

Proposed Times of Trading:

Monday to Saturday 0900 hours until 0300 hours on the days following
Sunday 0900 hours until 23.59 hours

To Display: Tables and Chairs

1. Detailed Considerations

1.1 The application was received by the Planning & Environment Department on 28 June 2012.

A copy of the application is attached as Appendix B4.

1.2 The application was duly advertised in the Croydon Guardian, no objections were received.

1.3 The Police licensing Officers, Food Safety team, Planning, Highways, Croydon BID and parking services divisions were invited to comment on this application, no objections have been received.

1.4 The measurements outlined above have been checked and agreed by an Enforcement Officer during a site visit.

- 1.5 Would the Committee please note that although the applicant has applied for the display of tables and chairs outside the full length of no's 80-88 , the current display is outside no 80 only.
- 1.6 A temporary licence was issued to the applicant which is valid until 21.1.2013 pending the committee's decision. A copy is attached as Appendix B5.
- 1.7 If the street designation order and street trading licence are granted, the applicant will provide a barrier around the tables and chairs in accordance with condition 6 on the temporary licence.
- 1.8 There is no other nearby premises in High Street who currently hold street trading licences. The site applied for is shaded on the attached map Appendix B6.
- 1.9 If the application for a street trading licence is granted the applicant will be invited to apply for a Street Trading Licence which will then be valid for a year.

Appendix B1

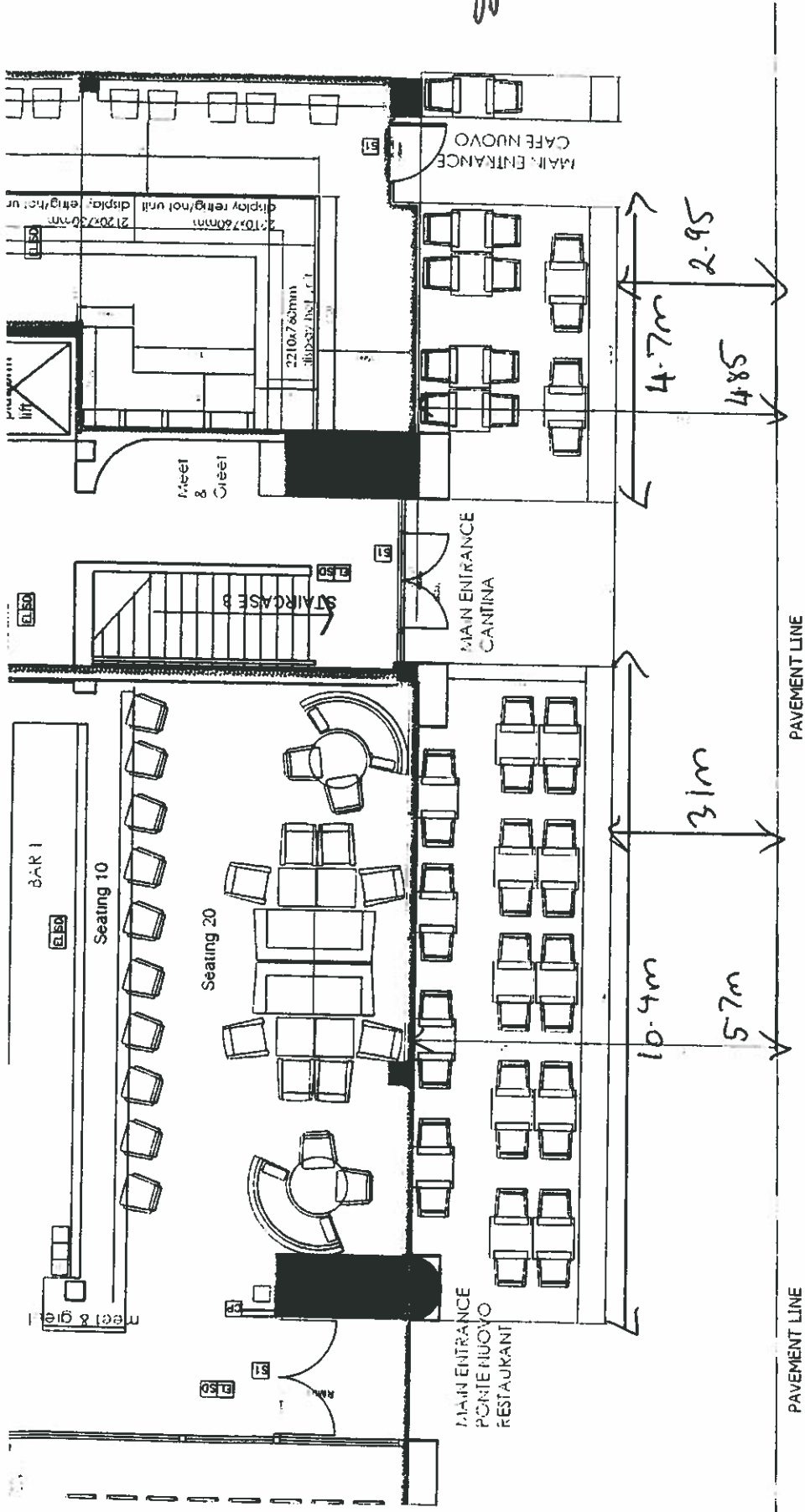

PROPOSED GROUND FLOOR PLAN

1:100, 1:200@A3

80-88 High 2nd

Appendix B1.



02 agosto 20

Ajuda 133

Caffè del  Ponte



Appendix B4

CROYDON
www.croydon.gov.uk

ACCESS CROYDON
21 JUN 2012

STREET TRADING LICENSING

APPLICATION FOR A STREET DESIGNATION ORDER

Return completed form to: Licensing Team, Planning & Environment Department, Croydon Council, 9th Floor North Side, Taberner House, Park Lane, Croydon, CR9 3JS. Telephone: 020 8760 5466 Fax: 020 8760 5786.

PLEASE READ THE GUIDANCE NOTES ATTACHED BEFORE COMPLETING THIS FORM

1. APPLICANT (see note A)

- a) First Name ANSELMO
- b) Last/Family Name CHIOFALO
- c) Full Home Address of Applicant [REDACTED]
- d) Home Tel No [REDACTED] e) Mobile No [REDACTED]
- f) E mail address: [REDACTED]
- g) Date of Birth: [REDACTED] h) Passport No [REDACTED]
- i) National Insurance No [REDACTED] j) Nationality: [REDACTED]

2. SITE TO BE DESIGNATED (see Note B) For Mobile Vehicles/Trailers go to section 4

- a) Trading Name of Premises: IL PONTE LIMITED
- b) Trading Address: 80 - 88 HIGH STREET CROYDON
CROINA
- c) Business Tel No: 0208 726 0654

3. DISPLAY AREA (see note C)

- a) Dimensions of display area (state whether measured in feet or metres)
Length 15m Width 2.6 Height —
- SEE THE ATTACHED PLANNER

Appendix B4

b) Hours that you would like to display the goods/services on the highway.

Sunday : from 0900 to 23.59 Thursday : from 0900 to 0300

Monday: from 0900 to 0300 Friday: from ↓ to ↓

Tuesday: from ↓ to ↓ Saturday: from ↓ to ↓

Wednesday : from ↓ to ↓

c) Type of goods or services to be displayed : Tables & Chairs
AS PER LICENCE

4. MOBILE VEHICLE/TRAILER (See note D)

a) Address of proposed pitch

b) Approx dimensions of vehicle/trailer (state whether measured in feet or metres)

Length.....Width.....Height.....

c) Registration No

d) Proposed hours and days of trading:

If you propose to sell hot food and drink after 2300 hours then you will require a premises licence under the Licensing Act 2003.(see note D)

Office Use only Premises Licence No

I declare that all the information given on this form is accurate to the best of my knowledge.

I enclose a fee of £ 347

Please make cheques payable to Croydon Council

Signature of applicant(s) or applicant's Solicitor or other duly authorised agent:

[Signature] Date 26/06

If you require any assistance with the completion of this form please contact the Licensing Team on 0208 760 5466

Office Use Only Uniform No: 12/00744/SJT

Receipt No : 170 22 Date received: 28/6/12

**TEMPORARY LICENCE –
STREET TRADING**

The Council of the London Borough of Croydon being the Local Authority for the purposes of the London Local Authorities Act 1990

**HEREBY LICENCE
TO USE SITE KNOWN AS**

Mr Anselmo Chiofalo
Il Ponte Nuevo
80-88 High Street
Croydon
Surrey
CR0 1NA

**TO DISPLAY
SIZE OF DESIGNATED DISPLAY**

Tables and Chairs
No 80 – Length 4.7m ,width 1.9m
No 82-88 - Length 10.4 m , width 2.6 m

PERMITTED DAYS & TIMES

Monday to Saturday 0900 hours until 0300
hours the following day
Sunday 0900 hours until 2359

This licence is issued subject to the conditions attached and is valid until **21.1.2013**

**Please note that the person named on the licence and whose photograph appears on the licence is responsible for the premises at all times.
This licence may not be transferred to any other person.**

Date Licence Issued: 21.07.2012

Date Licence Valid From: 21.07.2012

Licence Number: 12/00744/STT



Michael Goddard
Trading Standards and Licensing Manager
Planning & Environment Department

Special Conditions

Non Transport for London Maintained Roads

1. The Licence shall ensure that there is a minimum clear passage of **2.0 metres** between the front edge of their display and the edge of the kerb or any item of street furniture (railings/lamp posts etc) – whichever is the nearer to the display
2. A clear copy of the licence shall be displayed in the front window of the premises at all times and should be visible to passers – by.
3. Please note that the person named on the licence and whose photograph appears on the licence is responsible for the premises at all times.
This licence may not be transferred to any other person.
4. The right to trade from the designated site will be temporarily suspended when Utility Companies or the Highway Authority require access to the footway to carry out necessary works, until the completion of those works.
5. The limits of the designated area may be marked on the footway/roadway by the Council to enable verification by Council & Highway Officers.
6. Premises displaying tables and chairs shall enclose the display area with a suitable barrier material e.g. rope.
7. The licence holder is responsible for removing all litter from the licensed area and adjacent footway at regular intervals during the day and at the close of business each day.

Appendix B6

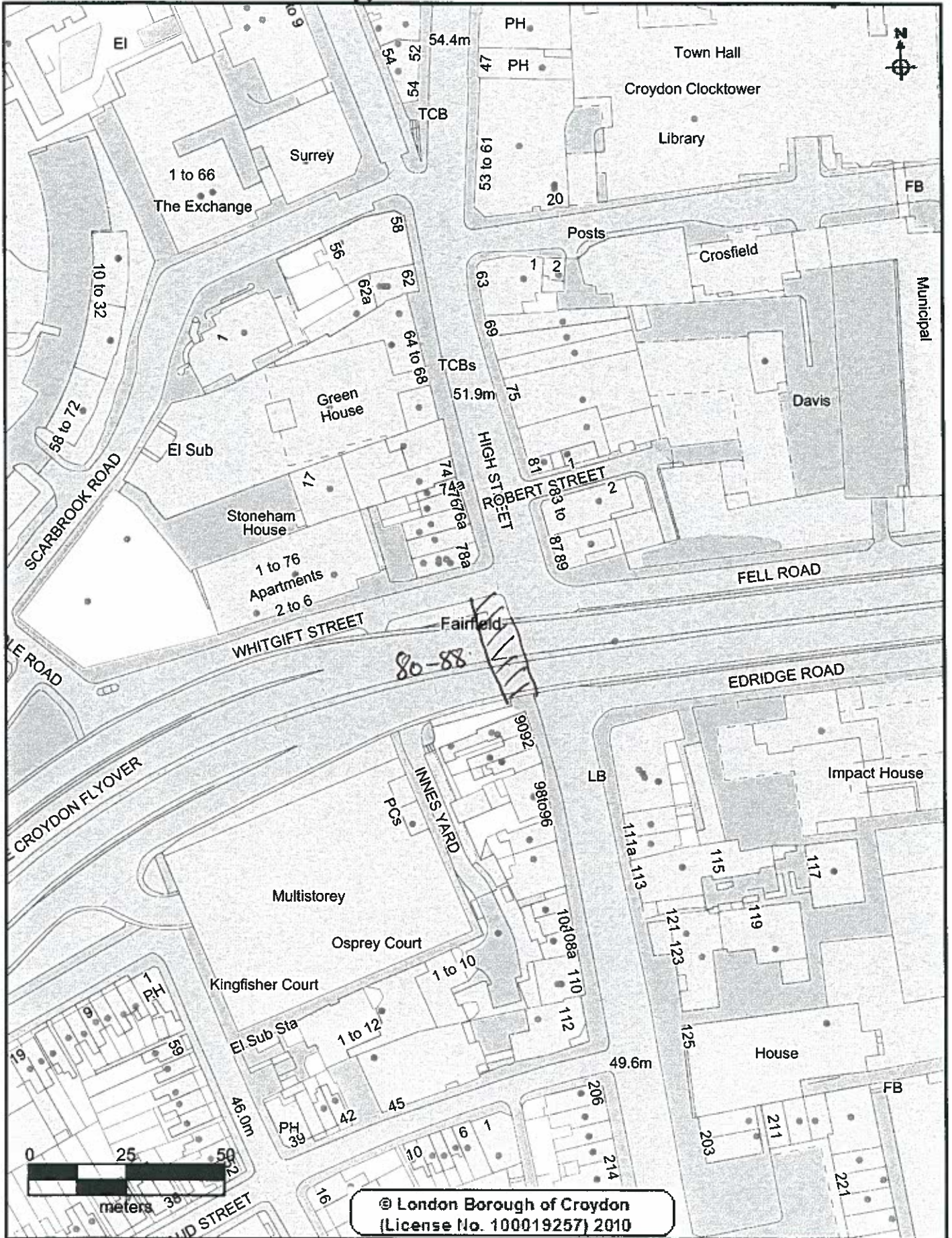

CROYDON
www.croydon.gov.uk

Crown Copyright Ordnance Survey (License No: 100019257) 2011

80-88 High Street

Scale 1:1250

19-Jul-2012

